



QUICKDRAIN PET POINT PAN KIT TECHNICAL SPECIFICATION

Job Name _____	Item # _____
Location _____	
Engineer _____	Contractor _____
PO # _____	Tag _____
Representative _____	

DESCRIPTION

The PET Point Pan shall be a tileable shower receptor for square drains and made from extruded rigid PET (polyethylene terephthalate) plastic foam. It is strong, lightweight, non-reactive, chemically stable, UV resistant, and suitable for interior and exterior use. The Point Pan can be used with both sheet and liquid topical waterproofing and eliminates the need for traditional mud bed installations. The compressive strength shall be 145PSI and meet IAPMO PS-10-2013 standards. It shall have the ability to be effortless and quickly modified to size and shape conditions on-site and is made from 100% post-consumer recycled plastic, and be fully recyclable.

APPLICATIONS/USES

- Industrial, commercial and residential showers
- Gang showers
- Pet Showers

SUITABLE SUBSTRATES (INTERIOR ONLY)

- Concrete
- Exterior Glue Plywood
- Cement backer board**
- OSB Or Avantech

**Consult cement backer board manufacturer for specific installation recommendations

APPROVALS AND LISTINGS

Before installing QuickDrain USA system, check with your local building department/plumbing inspector to ensure compliance with the local building codes. QuickDrain USA LLC is not responsible for any conflicts with local building codes. QuickDrain USA LLC is not responsible for improper installation of any part of the assembly or the waterproofing membrane. Dimensions are subject to manufacturer's tolerance and can change without notice.



PRODUCT SELECTOR

PET SQUAREDRAIN SLOPE				
✓	Slope Size	Flange Recess	Product Number	Required Additional Product
	36" x 36"	Small	SDPAN36-SF	CPD04
	36" x 36"	Large	SDPAN36-LF	CPD05, CPD06
	48" x 48"	Small	SDPAN48-SF	CPD04
	48" x 48"	Large	SDPAN48-LF	CPD05, CPD06
	24" x 36"	N/A	SDQSEX2436	SDPAN36-SF, SDPAN36-LF
	24" x 48"	N/A	SDQSEX2448	SDPAN48-SF, SDPAN48-LF

Dimensions continued on next page.

SDPAN36-SF

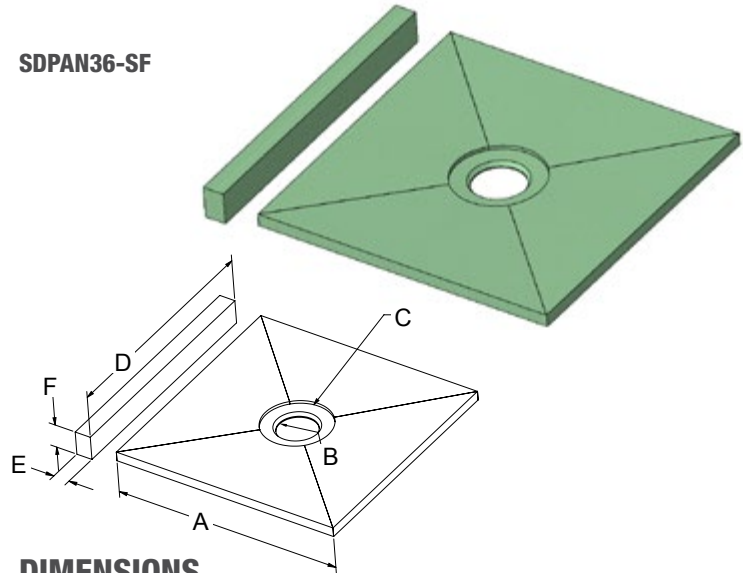

DIMENSIONS

[A]:	Pan Size:	36" x 36"	[D]:	Curb Length	36"
[B]:	Thru Hole	6"	[E]:	Curb Width	2-1/2"
[C]:	Flange O.D.	10-1/2"	[F]:	Curb Height	3-13/16"

SDPAN36-LF

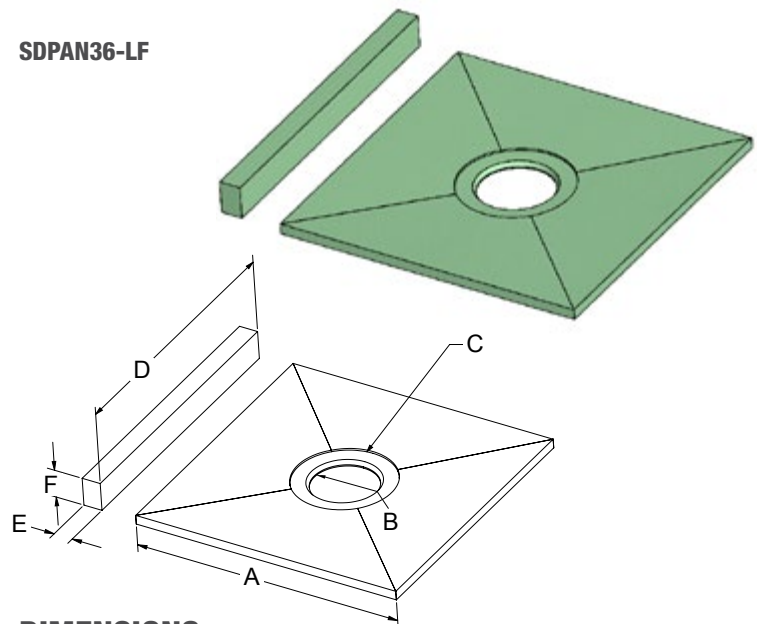

DIMENSIONS

[A]:	Pan Size:	36" x 36"	[D]:	Curb Length	36"
[B]:	Thru Hole	8-1/2"	[E]:	Curb Width	2-1/2"
[C]:	Flange O.D.	13"	[F]:	Curb Height	3-13/16"

Access BIM/Revit content through www.quickdrainusa.com



**QUICKDRAIN
PET POINT PAN KIT
TECHNICAL SPECIFICATION**

SDPAN48-SF

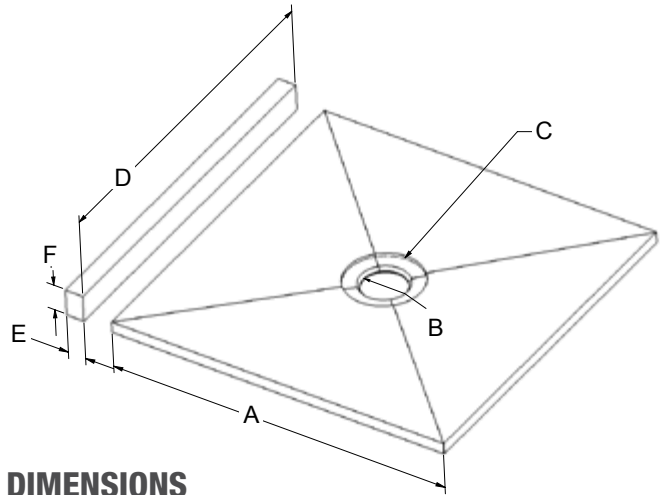
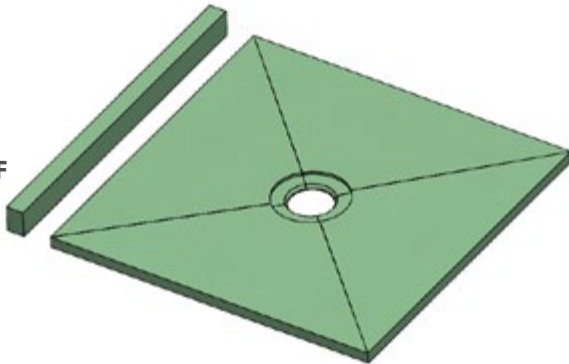

DIMENSIONS

[A]:	Pan Size:	48" x 48"	[D]:	Curb Length	48"
[B]:	Thru Hole	6"	[E]:	Curb Width	2-1/2"
[C]:	Flange O.D.	10-1/2"	[F]:	Curb Height	3-13/16"

36" x 24" Extension

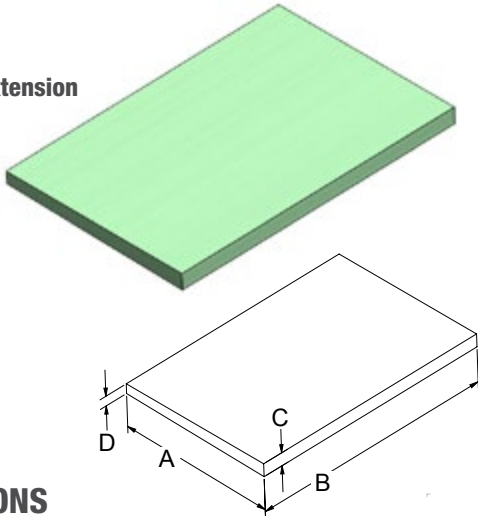

DIMENSIONS

[A]:	Length:	24"	[C]:	Tall End	1.5"
[B]:	Width:	36"	[D]:	Low End	2"

SDPAN48-LF

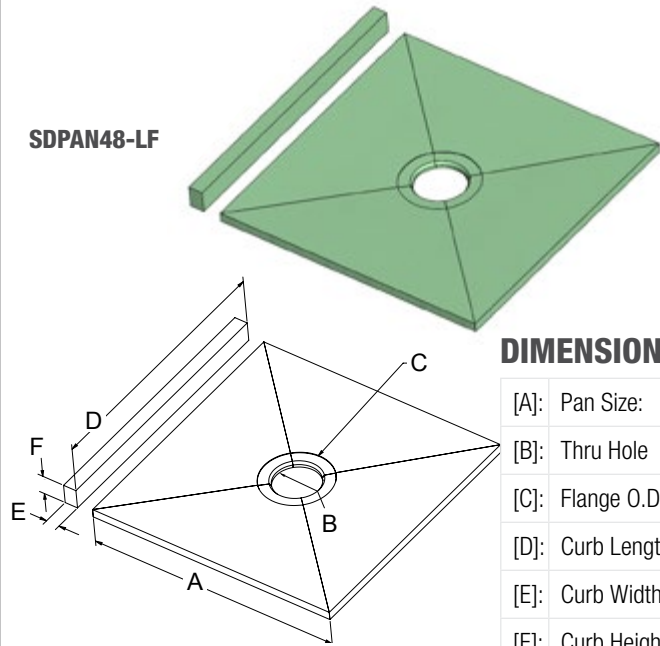

DIMENSIONS

[A]:	Pan Size:	48" x 48"	[B]:	Thru Hole	8-1/2"
[C]:	Flange O.D.	13"	[D]:	Curb Length	48"
[E]:	Curb Width	2-1/2"	[F]:	Curb Height	3-13/16"

48" x 24" Extension

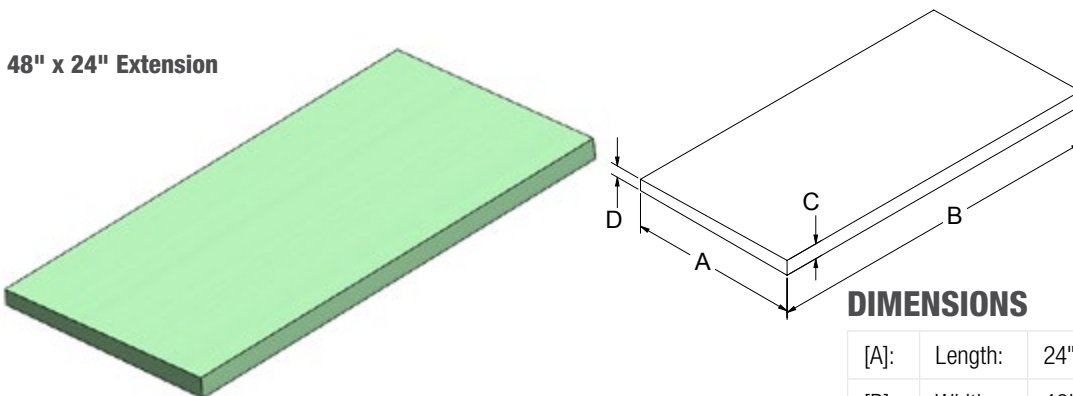

DIMENSIONS

[A]:	Length:	24"	[C]:	Tall End	2"
[B]:	Width:	48"	[D]:	Low End	1.6"

Access BIM/Revit content through www.quickdrainusa.com