

Features

- Chemically stable, UV resistant and suitable for both interior and exterior use
- Can be used with both sheet and liquid topical waterproofing
- Speed and consistency of installation
- Eliminates the need for traditional mud bed installations
- Lightweight, durable with high compressive strength 145PSI
- Meets IAPMO PS-106-2013
- 100% Post consumer recycled and fully recyclable



Suitable Substrates (Interior Only)

- Concrete
- Exterior Glue Plywood
- Cement backer board**
- OSB or Avantech

***Consult cement backer board manufacturer for specific installation recommendations*

Uses

- Interior and exterior use
- Industrial, commercial and residential showers
- Gang showers
- Pet showers

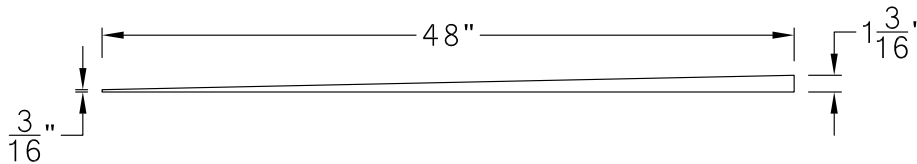
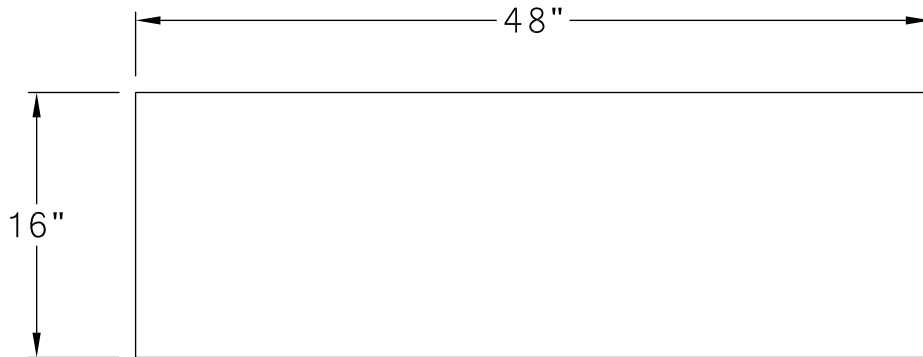

Quick Slope ADA Dimensions